

# 1646-1648 County Road 565 Vernon NJ

1646-1648 County Road 565, Vernon, NJ 07461

**\$165,000**  
MLS# 3960546



View virtual tour at:  
<https://tourwizard.net/23acres/>



23 acres of heavily wooded property. Possible subdivision, stream on lot. Many possibilities Setbacks 75 feet front and rear 25 feet on sides. 35 feet tall and 2 and half stories tall. Schedule A, R2 approval attached. Permitted usages: Agricultural farm, clubhouse, Cluster development, Community residences for the developmentally disabled, family daycare, single family, daycare, home occupation, nature preserve, outdoor recreation, recreational facility personal.

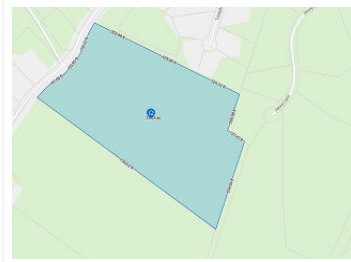

**Michael Bisk**  
Broker / Salesperson

(908) 451-4400  
[michael.bisk@outlook.com](mailto:michael.bisk@outlook.com)  
<http://www.michaelbisk.info>

**Coldwell Banker Realty**

(908) 451-4400  
[michael.bisk@outlook.com](mailto:michael.bisk@outlook.com)  
<http://www.michaelbisk.info>

